

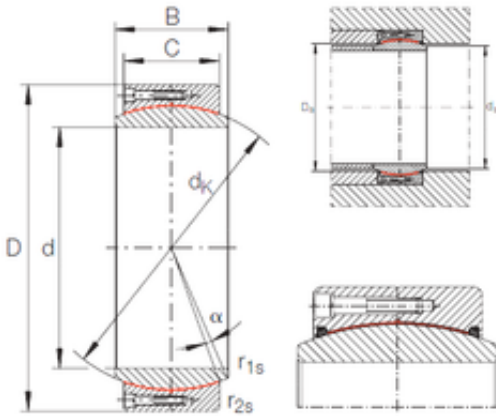

Qingdao Flow Group Limited

750 mm x 1000 mm x 335 mm INA GE 750 DW plain bearings

Bearing No. GE 750 DW



GE 750 DW Bearing 2D drawings and 3D CAD models

Size	750x1000x335 mm
Bore Diameter	750 mm
Outer Diameter	1000 mm
Width	335 mm
d	750 mm
D	1000 mm
B	335 mm
C	280 mm
dk	875 mm
r1 min.	3 mm
r2 min.	6 mm
da max	808,3 mm
Da min	834 mm
Angle	3,8 °
Weight	784 Kg
Basic dynamic load rating (C)	73,5 kN